

LEGAL DESCRIPTION (COMBINED PARCELS): THE WEST 1/2 OF THE SOUTHEAST 1/4, LYING SOUTH OF THE C&O RAILROAD RIGHT-OF-WAY, SECTION 8, TOWN 2 NORTH, RANGE 5 EAST, GENOA TOWNSHIP, LIVINGSTON COUNTY, MICHIGAN...

RECORD LEGAL DESCRIPTIONS: 11-08-400-004 SITUATED IN THE TOWNSHIP OF GENOA, COUNTY OF LIVINGSTON, STATE OF MICHIGAN TO WIT: THE SOUTH 5 ACRES OF THE NORTH 1/2 OF THE SOUTH 30 ACRES OF THE EAST 1/2 OF THE SOUTHEAST 1/4 OF SECTION 8, TOWN 2 NORTH, RANGE 5 EAST, GENOA TOWNSHIP, LIVINGSTON COUNTY, MICHIGAN.

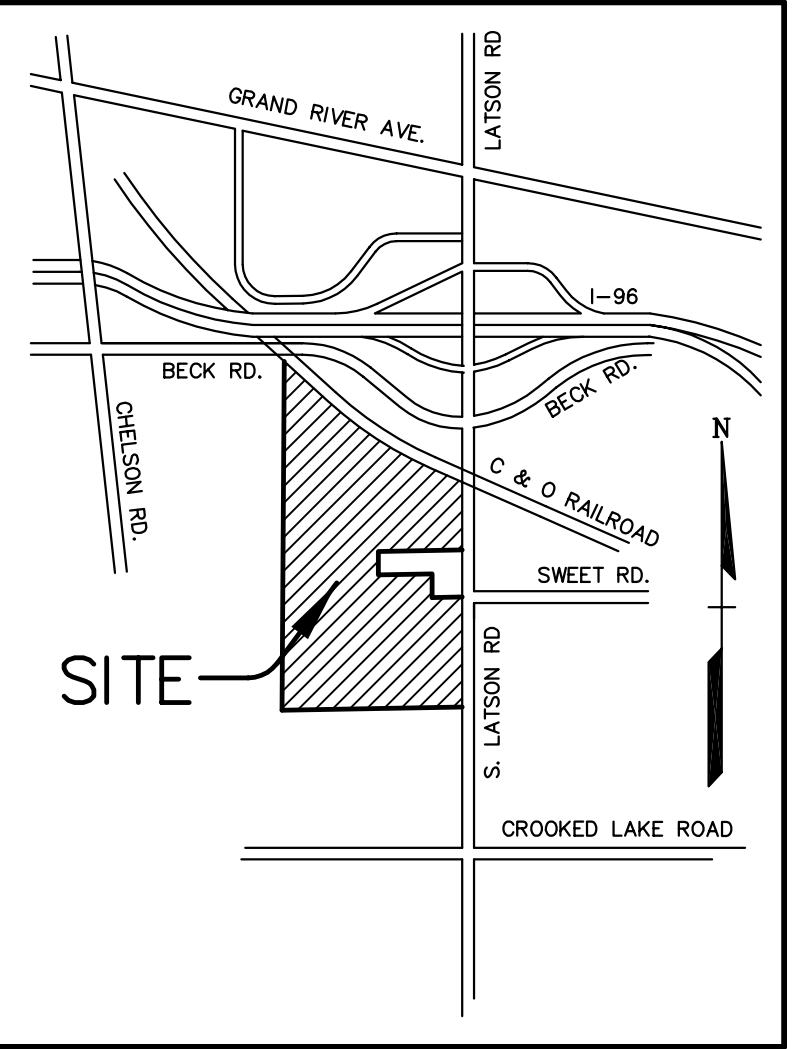

SURVEYOR'S NOTES: 1- PARCEL ZONED : CE (COUNTRY ESTATE) 2- MINIMUM SETBACKS: FRONT 75 FEET, SIDE 40 FEET, REAR 60 FEET 3- MAXIMUM HEIGHT OF BUILDING: 35' 4- THE PROPERTY IS IN ZONE X (AREA OF MINIMAL FLOOD HAZARD) SOURCE: FLOOD INSURANCE RATE MAP PANEL NUMBERS: 2609300309D & 2609300330D EFFECTIVE DATE 9/17/2008 5- SITE AREA : 177.935 ACRES

Private Road Easement (11-08-400-012, 11-08-400-013, 11-08-400-014 & 11-08-400-015) Private Road Easement - A 66 foot wide strip of land located in the southeast 1/4 of Section 8, Town 2 North, Range 5 East, Genoa Township, Livingston County, State of Michigan for purpose of ingress and egress and the location of public and private utilities, the centerline of which is described as follows: Beginning at a point on the East line of said Section 8, distant Due North 252.46 feet from the Southeast 1/4 corner of said Section 8; thence South 88 degrees 44 minutes 11 seconds West 970.35 feet to the center of a 75 foot radius turnaround; thence continuing South 88 degrees 44 minutes 11 seconds West 323.54 feet to the point of ending.

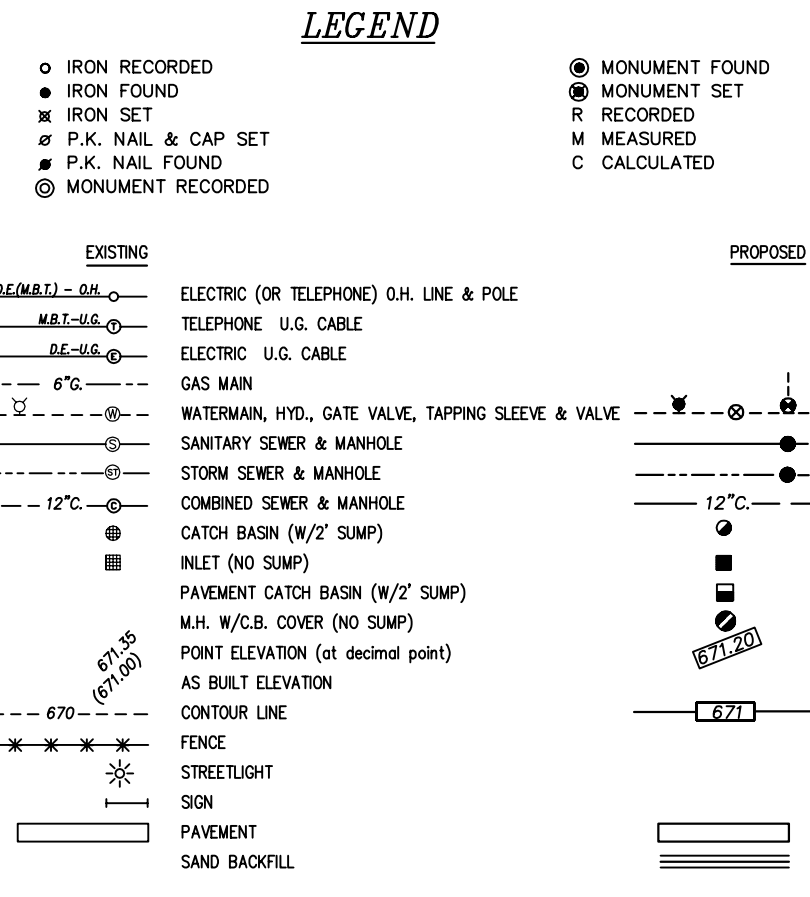

PARCEL 11-17-200-008 VANGUARD TITLE COMPANY AGENT FOR: FIRST AMERICAN TITLE INSURANCE COMPANY COMMITMENT No. V6202678 (EFFECTIVE DATE: JUNE 10, 2016) (LAST REVISED: JUNE 28, 2016) ITEM #8 OIL AND GAS LEASE BETWEEN LESLIE W. LATSON AND GLADYS M. LATSON, AS LESSOR, AND ARTHUR S. STORM, AS LESSEE, RECORDED IN LIBER 168 PAGE 138, AND ANY SUBSEQUENT INSTRUMENTS PERTINENT THERETO, LIVINGSTON COUNTY RECORDS.

SURVEYOR'S CERTIFICATE TO: LATSON PARTNERS, LLC VANGUARD TITLE COMPANY FIRST AMERICAN TITLE INSURANCE COMPANY THIS IS TO CERTIFY THAT THIS MAP OR PLAT AND THE SURVEY ON WHICH IT IS BASED WERE MADE IN ACCORDANCE WITH THE 2016 MINIMUM STANDARD DETAIL REQUIREMENTS FOR ALTA/NSPS LAND TITLE SURVEYS, JOINTLY ESTABLISHED AND ADOPTED BY ALTA AND NSPS, AND INCLUDES ITEMS 1-6, 8, 10, 11 AND 13 OF TABLE "A" THEREOF. THE FILED WORK WAS COMPLETED ON 09-16-2016. Signed: NICOLA MARINI Registration MI No. 26462 DATED: 09-18-2016

PARCEL 11-08-400-020 - OIL AND GAS MINING LEASE IN FAVOR OF ARTHUR S. STORM AS RECITED IN INSTRUMENT RECORDED IN LIBER 168, PAGE 138. - OIL AND GAS LEASE IN FAVOR OF PANHANDLE EASTERN PIPE LINE COMPANY, AS LESSEE, AS DISCLOSED BY INSTRUMENT RECORDED IN LIBER 292, PAGE 355, LIBER 225, PAGE 86, LIBER 215, PAGE 432, LIBER 292, PAGE 67 AND LIBER 298, PAGE 250.

Table with columns: REV. BY, CHK. BY, REVISIONS, DATE. Includes company information for LATSON PARTNERS, LLC and ALTA SURVEY, and contact info for Engineering and Surveying Services, Inc.